

\$850,000 - 500 Parkins Avenue, Rural Lac Ste. Anne County

MLS® #E4382358

\$850,000

0 Bedroom, 0.00 Bathroom,
Land Commercial on 0.00 Acres

None, Rural Lac Ste. Anne County, AB

Discover 44+/- acres of boundless outdoor opportunities nestled in the Summer Village of Ross Haven! Formerly a golf course. Embrace lakeside living as you envision your dream home, just steps away from the shores of Lac Ste Anne. Offering year-round recreational outdoor activities conveniently situated, just 30 minutes to Stony Plain/Spruce Grove and 45 minutes to Edmonton. Experience the perfect blend of tranquility and accessibility on your own piece of lakeside paradise. Water wells on property.

Essential Information

| | |
|-----------|-----------------|
| MLS® # | E4382358 |
| Price | \$850,000 |
| Bathrooms | 0.00 |
| Acres | 0.00 |
| Type | Land Commercial |
| Status | Active |

Community Information

| | |
|-------------|----------------------------|
| Address | 500 Parkins Avenue |
| Area | Rural Lac Ste. Anne County |
| Subdivision | None |
| City | Rural Lac Ste. Anne County |

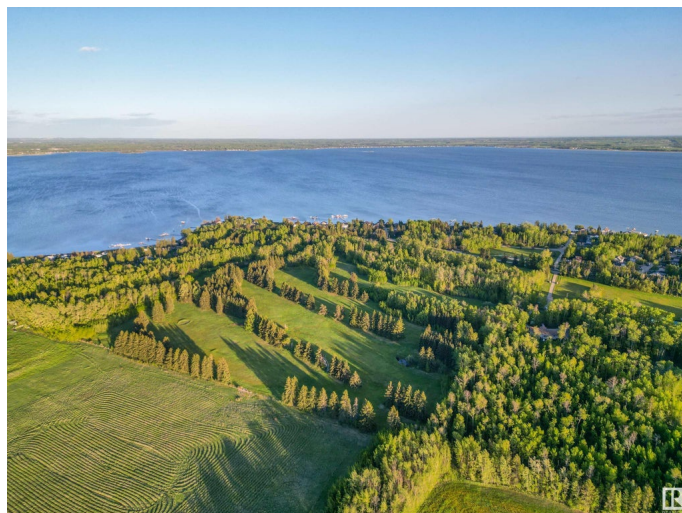
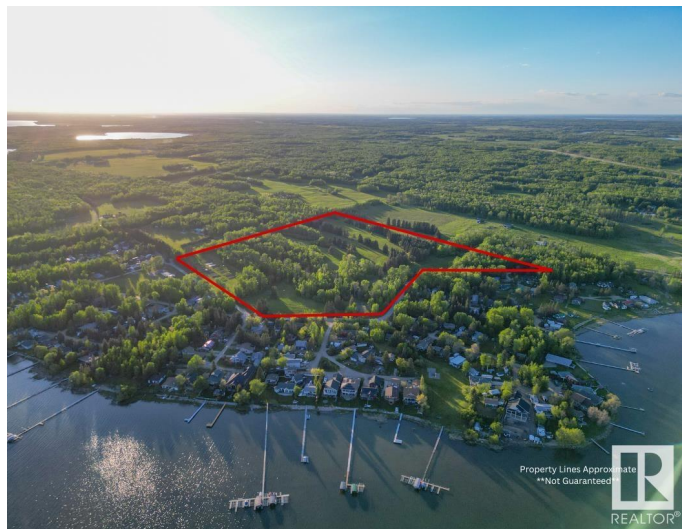

| | |
|-------------|---------|
| County | ALBERTA |
| Province | AB |
| Postal Code | T0E 1A0 |

Additional Information

| | |
|----------------|------------------|
| Date Listed | April 16th, 2024 |
| Days on Market | 367 |
| Zoning | Zone 70 |

DATA IS DEEMED RELIABLE BUT IS NOT GUARANTEED ACCURATE BY THE REALTORS® ASSOCIATION OF EDMONTON. COPYRIGHT 2025 BY THE REALTORS® ASSOCIATION OF EDMONTON. ALL RIGHTS RESERVED.Trademarks are owned or controlled by the Canadian Real Estate Association (CREA) and identify real estate professionals who are members of CREA (REALTOR®, REALTORS®) and/or the quality of services they provide (MLS®, Multiple Listing Service®)

Listing information last updated on April 18th, 2025 at 7:17pm MDT